



THE UNEXPECTED

STUDIO III
ENSHCER+MUSEUM PROJECT

KABK INSIDE MASTER INTERIOR ARCHITECTURE

*Dylana Eunhye Kim
Vittoria Colangelo*



A new large spherical object inhabits/planted in the courtyard of the museum. New 'life', which provides an unexpected spatial experience both inside as well as when it confronts/engages with the existing building, courtyard and basement.

Inspired by Escher's work, 'Hand with Reflecting Sphere, 1935', the bold shape became our project's main target where visitors would experience the unexpected. Entering the space itself, covered with reflective mirror from outside and inside. Organic and natural shaped sitting, resting and observing area with one side clean cut seminar/lecture area on the side. Symbolic ramp that connects existing building and the ball structure like a loop will let visitor to experience overall atmosphere of Escher's museum-hotel. Illusionistic light structure will be hang on the air inside of the sphere, people will feel several layers of illusion, one from the mirror-effect, and the other from the view from the ramp above, and last and the least, the optical illusion light hang on the air will give people experience extreme.

Provocative but not unrealistic. The sphere relates to Escher's works and his fascinations. If this would be realized, then the museum would instantly be known for this new volume. Escher's art is as entertainment.

STUDY PHASE

MASS STUDY



1

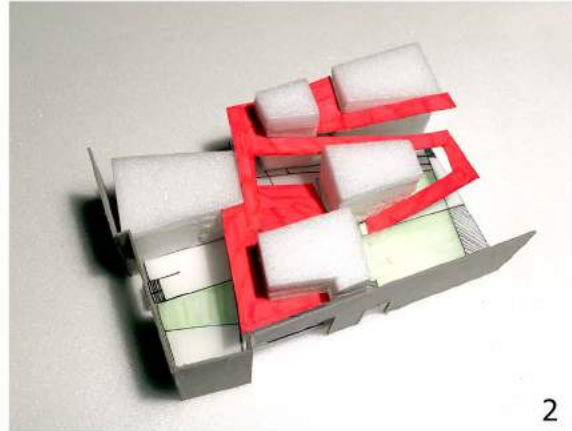

2

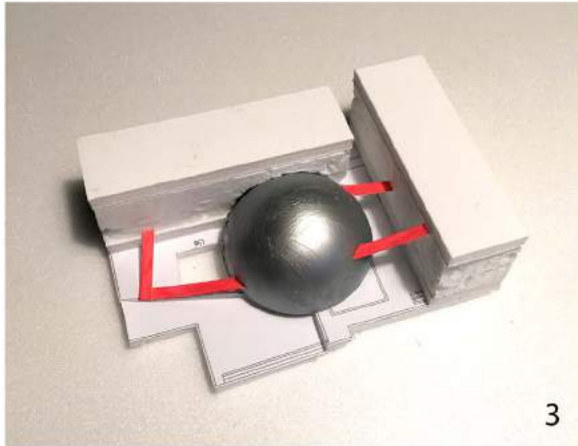

3

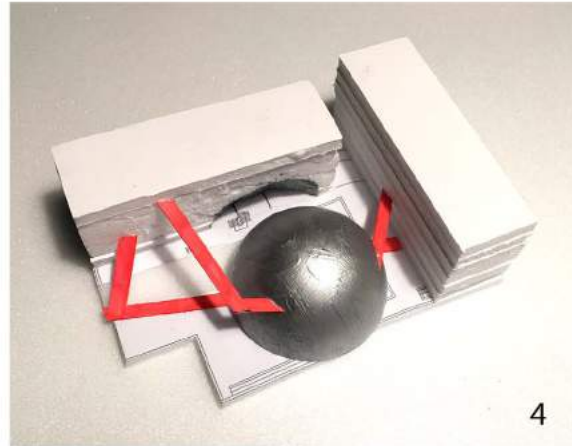

4

SKETCHES

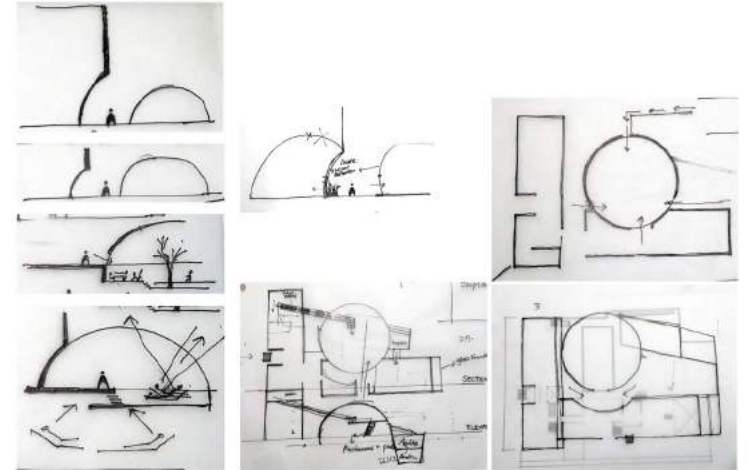

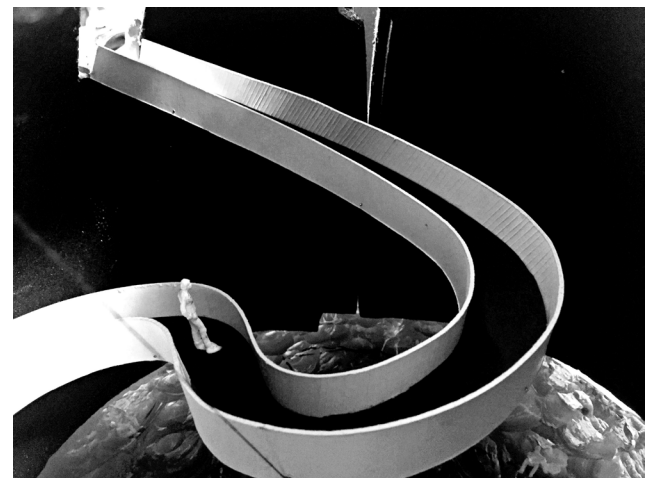
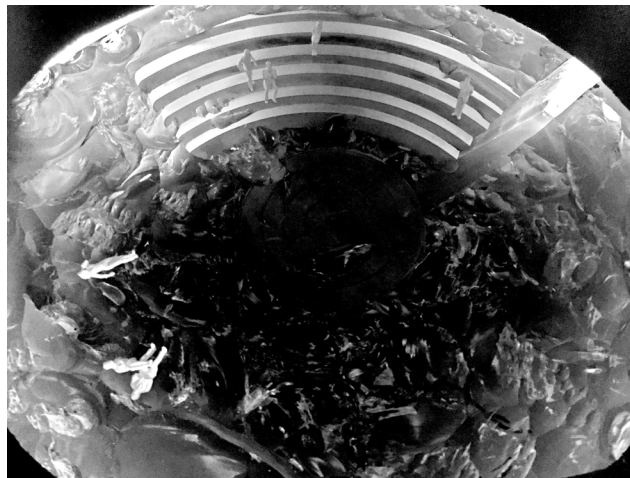
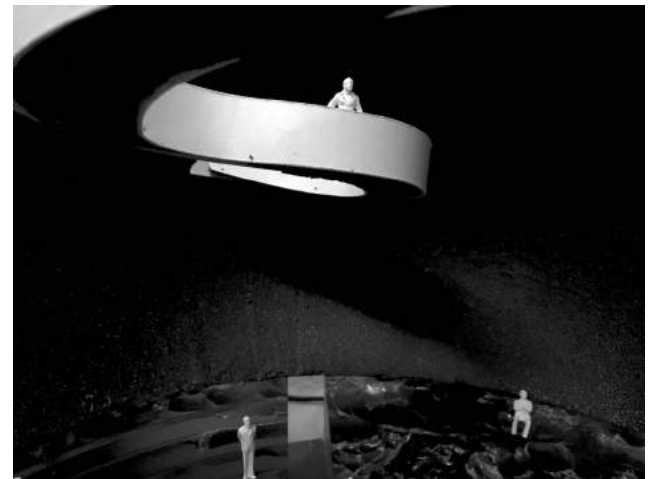
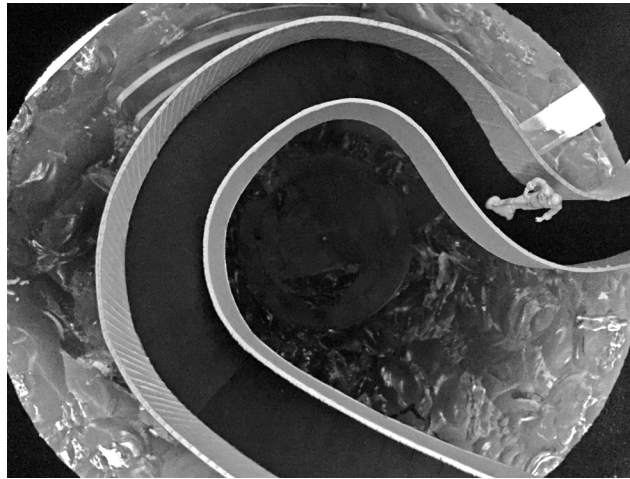
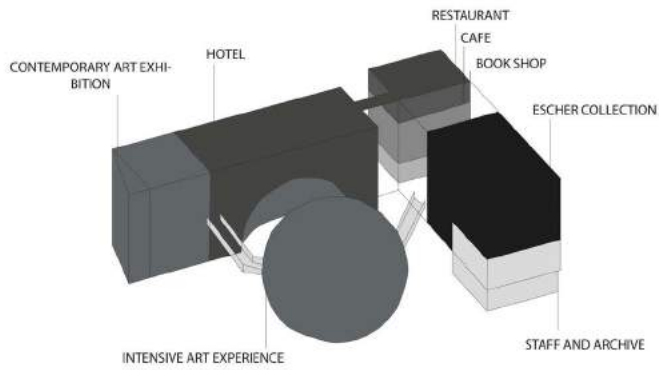
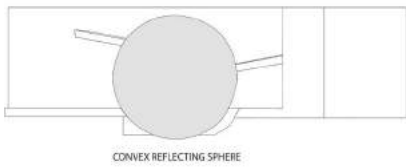

INTERVENTIONS

